

WP-Compact Series

DC Power Distribution

300 Amps Continuous Rating Manual Battery Switches



Datasheet



No compromise in safety and reliability, Around the battery

When leaving the marina and heading for the ocean, you are getting fully dependent on your boat electrical system. With WhisperPower, you are secured electricity is guided into the appropriate conduits which prevents dangerous situations. The WhisperPower DC distribution program offers high quality components ensuring a safe and enjoyable trip.

- Robust and compact design
- Tin-plated copper studs for maximum conductivity and corrosion resistance
- Multiple cable terminals, 22mm stud length
- One piece terminal design prevent loosens over time
- Multiple cable input, allows surface, rear, or front panel mounting options.
- Circuit identification label included
- Ce marked, Iso 8846
- UI listed- UL1701 electrical power switches
- Meets American Boat and Yacht Council requirements
- Meets UI1500 and SAE J1171 external ignition protection requirements
- IP66- protected against powerful water jets

When setting up the battery banks of your 12 or 24V system, the required capacity and choice of battery type are not the only important elements. Vital components around the battery are at least as important. WhisperPower provides you with all the necessary high quality components to perfectly round off your installation. WhisperPower offers a complete program of manual and remote operated battery switches.

Manual operated WP-Compact series or WP-Heavy Duty series, manual ON/OFF switches to connect/disconnect DC consumers and/or battery bank.

Remote operated – WP-ML Bi-stable low current draw remote battery switch/magnetic latch, for remote ON and off switching of the DC consumers and/or battery bank.



green energy solutions



green energy solutions



Series Article no.	WP-Compact Series 50214701	WP-Compact Series 50214702	WP-Compact Series 50214703
Model type	Manual battery switch	Manual battery switch	Manual battery switch
Circuit type	on-off	dual circuit	dual circuit + combine
Input			
Battery input	1	2	2
Switch Positions	2	4	3
Battery combine function	-	yes	yes
I 10 Cranking rating 10 sec	1500 A	1500 A	1500 A
I 60 Cranking rating 1 min	775 A	775 A	775 A
I 300 Cintermittent rating 5 min	500 A	500 A	500 A
I C continue rating	300 A	300 A	300 A
Vmno Voltage maxium Operation	48VDC	32VDC	32VDC
General			
Ambient operation temperature	-20 C ... +40C	-20 C ... +40C	-20 C ... +40C
Storage temperature	-25 C ... +85C	-25 C ... +85C	-25 C ... +85C
Operating humidity	95%, non condens	95%, non condens	95%, non condens
Mechanical			
Connections terminal stud	M10 (3/8"-.16)	M10 (3/8"-.16)	M10 (3/8"-.16)
Connections stud lenght	22 mm	23 mm	24 mm
Maximum terminal Stud Torque	13.56 NM (120 in-lb)	13.56 NM (120 in-lb)	13.56 NM (120 in-lb)
Terminal material	tin-plated copper	tin-plated copper	tin-plated copper
Enclouser width	72 mm	72 mm	72 mm
Enclouser height	78 mm	78 mm	78 mm
Weight	0.28 kg	0.28 kg	0.28 kg
Drilling mounting centers	55 mm	56 mm	57 mm
Rear panel mount diameter	59 mm dia	60 mm dia	61 mm dia
Mounting screws	10 mm	11 mm	12 mm
Ingress Protection Class	IP66	IP67	IP68
Enclouser Colour	RAL9011 Graphite Black	RAL9011 Graphite Black	RAL9011 Graphite Black
Calbe clearance	28 mm (1.12")	29 mm (1.12")	30 mm (1.12")
Ignition Protection	UI 1500 SAE J1171	UI 1500 SAE J1172	UI 1500 SAE J1173
Markings	CE, Iso 8846	CE, Iso 8847	CE, Iso 8848

Circuit type on-off

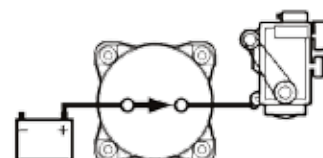

Switch Set to 'ON'

Circuit type dual circuit

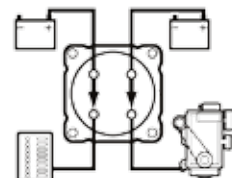

Switch Set to 'ON'
Isolated Battery Banks

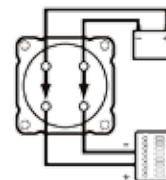

Switch Set to 'ON'
One Battery Banks

Circuit type dual circuit + combine

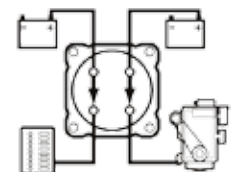

Switch Set to 'ON'

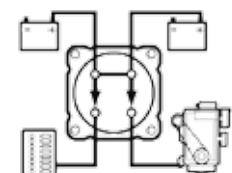

Switch Set to 'Combine Batteries'

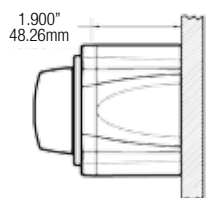
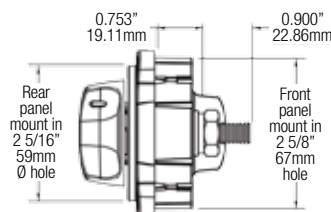
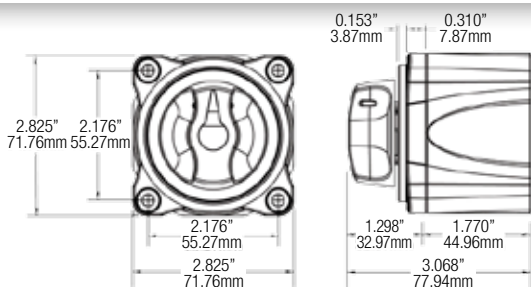

Surface mounting

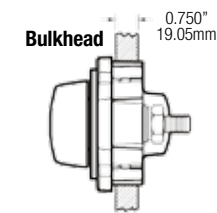

Front panel mounting

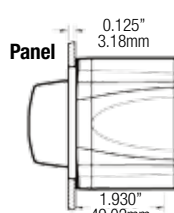

Rear panel mounting

Switch Mounting Options