



Model: W-GV 8 Elite outdoor
DIESEL GENERATOR FOR MOBILE USE
Voltage: 1 Phase 117 V / 60 Hz (230 V, 50 Hz)
Power Rating: 8 kVA, 6 kW



Engine Features

- Diesel fueled
- Certified by Environmental Protection Agency (EPA) in conformity to Tier IV mobile auxiliary
- Stage V Emission Class (EU)
- Two cylinder
- Four stroke
- Closed cooling system
- Exhaust manifold liquid cooled
- Electric fuel lift pump
- Lifting eye

Generator Features

- High efficient brushless permanent magnet alternator
- Inverter based output (PMG)
- Class H insulation
- Speed adjustability (2200 - 2800 RPM)
- Liquid cooled
- Engine and generator are thermally separated from each other

Benefits

- Compact assembly, includes robust stainless steel sound shield
- Available with integrated exhaust system (2 mufflers)
- Optional underfloor mounting frame
- Plug and play monitoring and control
- Extremely silent (52 - 60 dBA, distance dependent)

Mechanical Dimensions and Weight

GENERAL SPECIFICATION	
Weight kg (lb.)	440 lb. (200kg)
Depth mm (in.) incl. suspension frame	29.2 (742)
Depth mm (in.) incl. exhaust	33.0 (837)
Width mm (in.)incl suspension frame	23.5 (597)
Width mm (in.) incl. exhaust	25.2 (640)
Height mm (in.) incl. suspension frame	26.38 (670)

* Incl suspension frame and exhaust, see drawing for all dimensions

Generator Power Output Specifications *)

POWER OUTPUT	
Nominal Power kW at 77°F (25°C)	6
Continuous power kVA at 77°F (25°C)	8
Continuous power kW at 77°F (25°C)	6

**Continuous ratings per ISO 3046, ISO 8528-1, guidelines for complete ratings definitions. Specifications are subject to change without notice.*

WhisperPower reserves the right to change the design or specifications without notice and without any obligation or liability whatsoever. Contact your local WhisperPower distributor for availability.

Technical Specifications 1

ENGINE

ENGINE SPECIFICATIONS	
Type	Kubota Z482 E4B-WPP 1
Cylinder, quantity	2
Displacement, L (cu. In.)	19.5 (479)
Bore, mm (in.)	3.07 (67)
Stroke, mm (in.)	2.64 (68.0)
Compression ratio	23.5:1
Combustion system	IDI
Nominal speed, rpm	2700
Max. power at rated rpm, kW	6 kW
Governor, type	Mechanical
Angular operation continuous	25°
ENGINE ELECTRICAL SYSTEM	
Starter Battery, voltage	12 V
Starter Battery, charging module	12,5 A
Starter Battery, minimum recommendation	55 Ah
COOLING SYSTEM	
Liquid coolant content	236 fl oz.
Radiator type	Single or Topcool
Radiator options	TopCool roof mount or radiator side mounting
FUEL SYSTEM	
Fuel shut-off solenoid	Electrical (ETR)
Fuel injection pump	Mechanical
Fuel lift pump	Electrical
Maximum recommended Fuel lift, m (ft.)	2.62 (0.8)
LUBRICATION SYSTEM	
Oil pump type	Pressure
Oil filter type	External
Oil pan capacity with filter, L (gal.)	2.8 (0,74)
Oil type	WPL-10W40

OPERATIONAL CONDITIONS

OPERATION REQUIREMENTS		50HZ
Engine Speed RPM		2600-2800
Air requirements, m³/hr (cu.ft)		57 (2012)
Fuel Consumption g/kWh		275
OPTIONAL: Crankcase heater		
OTHER SPECIFICATIONS		
Exhaust system		1" tread pre-mounted dual muffler
Exhaust end pipe		pre-mounted and easy adjustable
Suspension frame		Pre-mounted with chassis dependent adapter
Minimal required free top space		3.93 in (10 cm)

Alternator Power Ratings at 77°F (25°C)

HIGH VOLTAGE PERMANENT MAGNET	0-400 VAC	16 Amps
----------------------------------	-----------	---------

HARMONIC DISTORTION < 3%

Configuration	1phase, series winding, 3wires
---------------	--------------------------------

Engine Features & Protection

- Low oil pressure shutdown
- High engine temperature shutdown
- Low vibration shock mounts
- Disposable oil filter
- Oil drain plug
- Disposable fuel filter

Alternator Features

- Aluminium water cooled starter housing
- Windings are vacuum impregnated with epoxy varnish for dependability and long life.
- Permanent magnet alternator (PMA).
- Copper windings ensure minimal heat build-up.
- Insulation meets standards for class H insulation.
- Flexible plate connection to the engine, the generator has a single end ball bearing with a precision-machined steel sleeve in the end bracket to prevent shaft misalignment and extend bearing life.

General Conditions

- Ventilated environment
- Operating temperature of 14 °F / + 104 °F
- Storage temperature of -4 °F / + 158 °F
- Relative humidity in operations / storage of max 75% RH, no-condensing

The Kubota Z482-E4B-WPP 1 has the certificates below
-Regulation (EU) 2016/1628

Technical Specifications 2



Optional:
5 inch Touch Panel

DDC - STANDARD CONTROL PANEL

- Full engine control
- Robust digital sensor readout
- DDC RS485 communication to Whisper Touch Panel
- LCD display with all relevant information regarding the output, maintenance hours, etc.
- Real time delivery load bar
- Automatic stopping at detected fault event
- Possibility to run the generator according a pre-programmed schedule
- Language by choice. German, English, French, Italian, Dutch, Spanish

DDC CONFIGURATION

W-GV 8 ELITE OUTDOOR

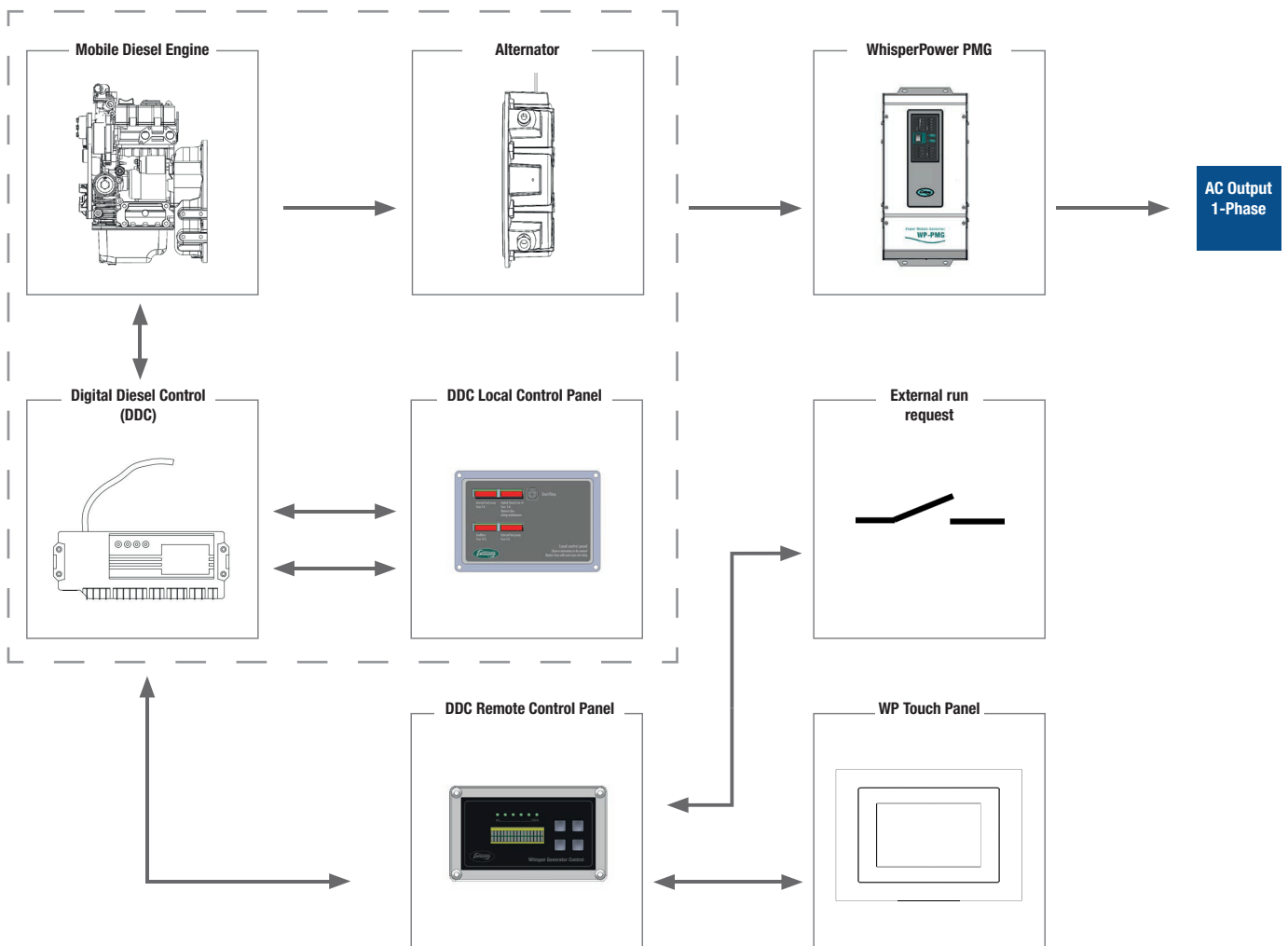

DRAWING 1

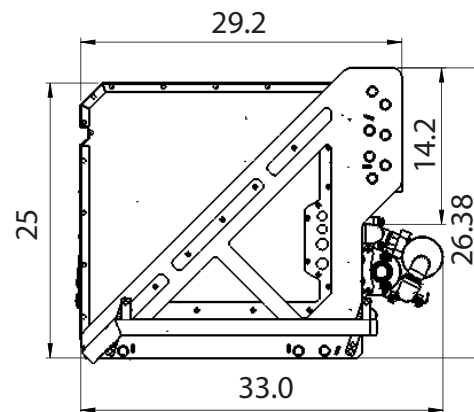
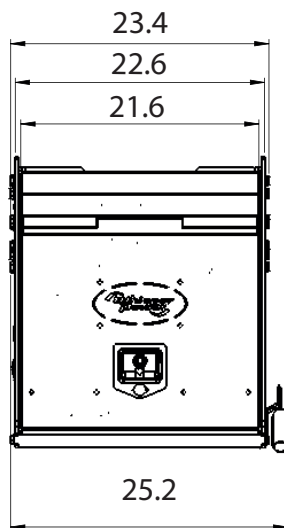
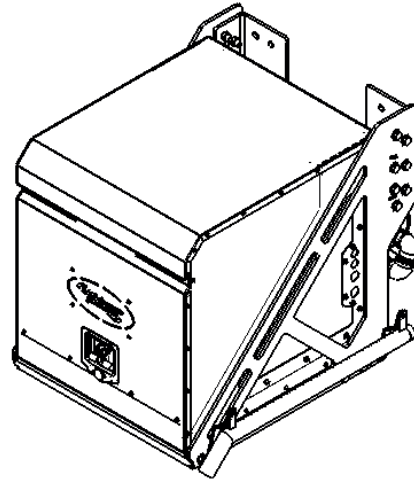
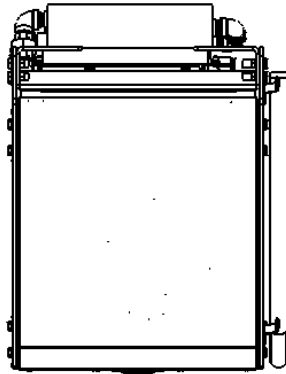

Example brackets,
not in Scope of Supply

